

The background image shows a street scene in downtown Seattle at dusk. The Space Needle is illuminated and stands prominently in the background. In the foreground, there are cars, a stop sign, and a street sign for 2nd Ave N. The scene is lit with streetlights and building lights, creating a warm glow against the darkening sky.

# North Downtown Mobility Action Program (NODO MAP)

*Investments around North Downtown and the New Arena at Seattle Center*



# Background and Purpose

- Oak View Group (OVG) is required to construct or contribute to transportation projects as part of the SDCI Master Use Permit (MUP) decision
- OVG will contribute \$40 million over 39 years to a City (Arena) Transportation Fund (CATF) at \$1,025,000 per year
- North Downtown Mobility Action Plan (NODO MAP) identified and prioritized the recommended projects to be implemented in the Uptown, South Lake Union, and Belltown neighborhoods



# Project Identification, Screening, Evaluation

## Oct. 2017 to Oct. 2018

- Community engagement for draft NODO Mobility Action Plan
- Existing plans
- Community input
- Arena Transportation and Mobility Subcommittee
- Interagency Working Group
- System needs identified by SDOT
- Went from over 500 project ideas down to 45 Tier 1 projects.





# Recent and Upcoming Transportation Projects in North Downtown



# Arena MUP Decision Projects



# NODO MAP Finalization and Execution Plan Development

## Oct. 2018 to Dec. 2019

- Prioritize Tier 1 projects
  - Assess how projects support guiding principals
  - Apply community input, agency support, system needs
  - Develop planning-level cost estimates for recommended projects
  - Leverage improvements by others
  - Determine schedule of projects based on anticipated new arena opening date (mid-2021) and other projects' schedules
- Refine project scope, assume project delivery method, identify team members, refine schedule and cost
- Confirm use of funding sources and partnerships to contribute to projects
- Finalization of NODO Mobility Action Plan (anticipated December 2019)



# NODO MAP Priority Projects



# NODO MAP Priority Projects

Project	Year											
	2018	2019	2020	2021	2022	2023	2024	2025	2026	2027	2028	2029
A: 1st Ave N and Queen Anne Ave N Complete Streets		Planning	Design	Construction								
B: 1st Ave and Broad St Complete Street Extension into Belltown		Planning	Design	Construction								
C-East: Thomas Street Greenway: Thomas/Dexter Protected Intersection		Planning	Design	Construction								
C-West: Thomas Street Neighborhood Greenway: Seattle Center to Waterfront		Planning	Design	Construction								
D: Pedestrian improvements in Belltown (1st Ave and Battery St signal)						Construction	Design	Construction				
E: Monorail Improvements Seed-Funding			Seed Funding									
F: Denny Way Corridor Signals*	Design	Design	Design	Construction								
G: Harrison St Corridor Signals*				Design	Design	Construction						
H: SR 99 to Waterfront Access and Mobility (Broad St) Signals*			Design	Design	Construction							
I: Neighborhood Programmatic Improvements				Design	Design	Construction	Construction	Construction	Construction	Construction	Construction	Construction
			Planning	Design	Design	Construction	Construction	Construction	Seed Funding	Seed Funding	Seed Funding	Seed Funding



# Highlights of Project B: 1<sup>st</sup> & Broad St Complete Street Extension

- Modification of 2nd Ave PBL by OVG to allow for 2-thru lanes on 2nd Ave for arena garage flush post-event
- Leverage improvements to complete bicycle connection from 2<sup>nd</sup> and Broad to new PBL at 1<sup>st</sup> Ave N
- Challenges:
  - Freight route
  - Transit impacts
  - Signals
  - Coordination with Denny Way ITS Project
  - Operational analysis of route

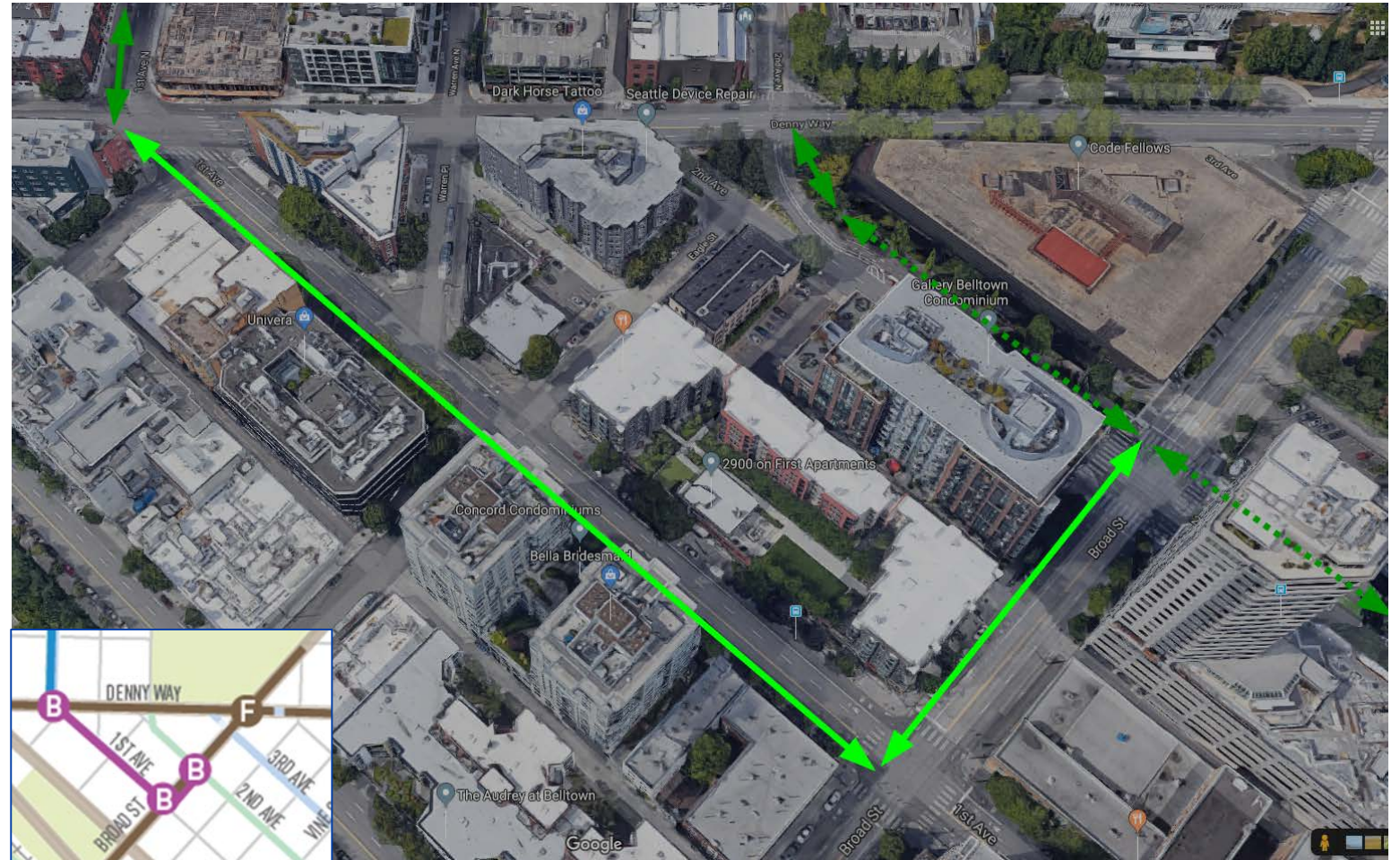

# Highlights of Project C-East: Dexter/Thomas Protected Intersection

- Leverage the reconstruction of Thomas St across 7th Ave to facilitate east-west pedestrian and bicycle travel between South Lake Union and Uptown.
- Associated with Thomas Street Redefined
- Challenges:
  - Active development in intersection
  - Coordination with WSDOT construction, SCL design, private development
  - Interim/early, permanent improvements





# Highlights of Project C-West: Seattle Center to Waterfront NGW

- Improve and highlight the route people use to walk and bike between the central waterfront and Seattle Center via the Thomas Street overpass
- Leverage improvements by OVG at 1<sup>st</sup> /Thomas and QA/Thomas
- Coordinate with Thomas Street Redefined – concept plan
- Advance baseline design schedule with intent to meet arena opening date



# Highlights of Project C-West: Seattle Center to Waterfront NGW

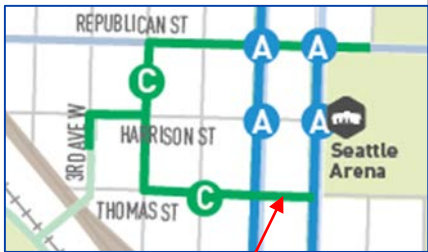
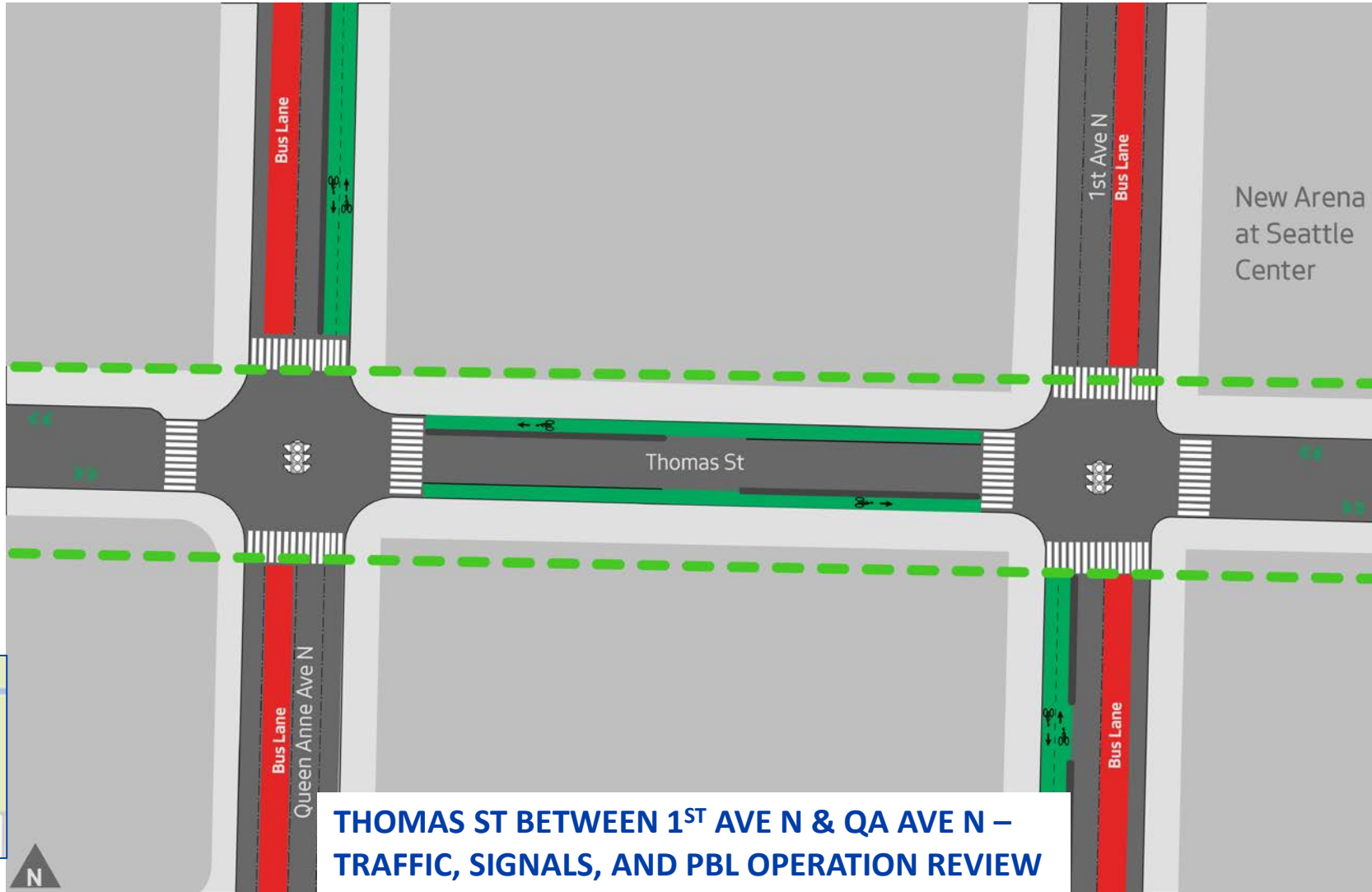



# Highlights of Project C-West: Seattle Center to Waterfront NGW

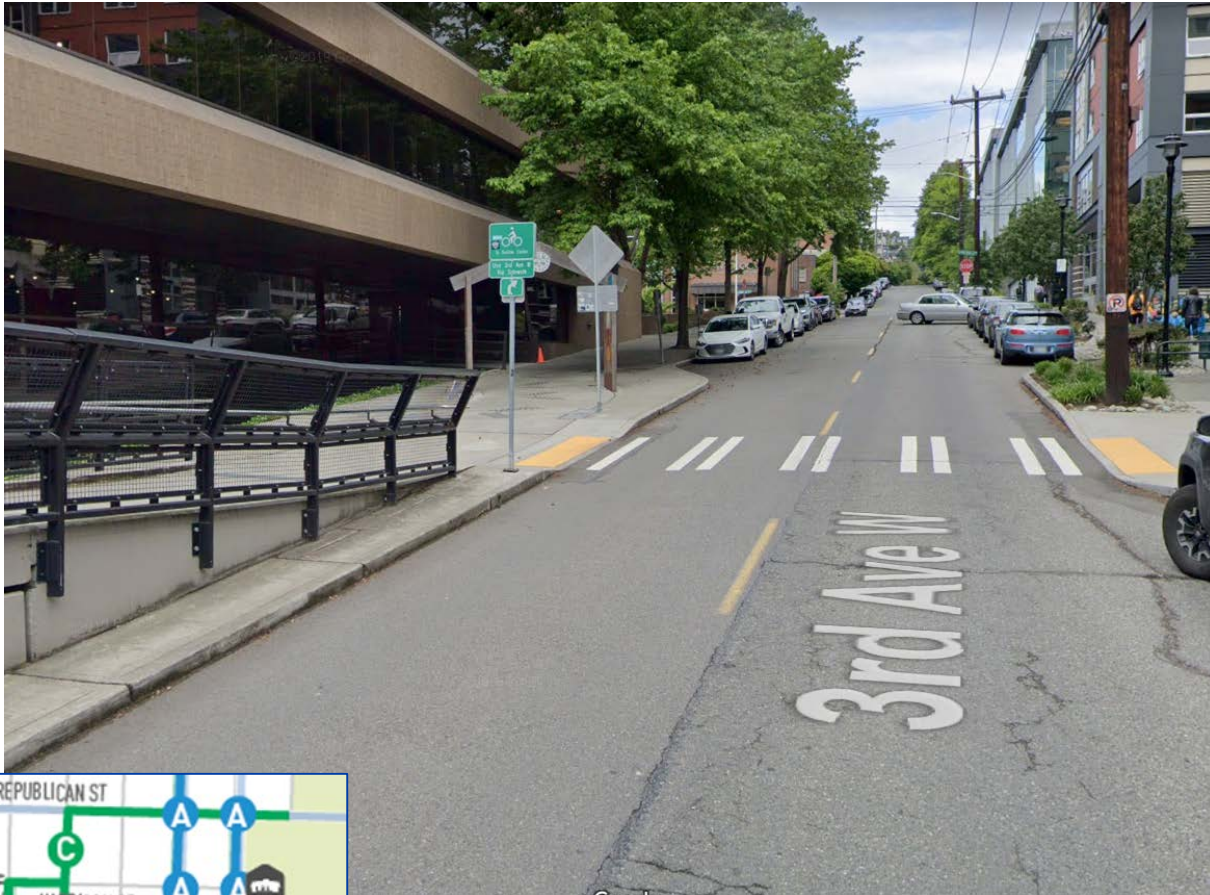

**REVIEWING OPTIONS FOR EASIER ACCESS ON AND OFF THOMAS ST OVERPASS**

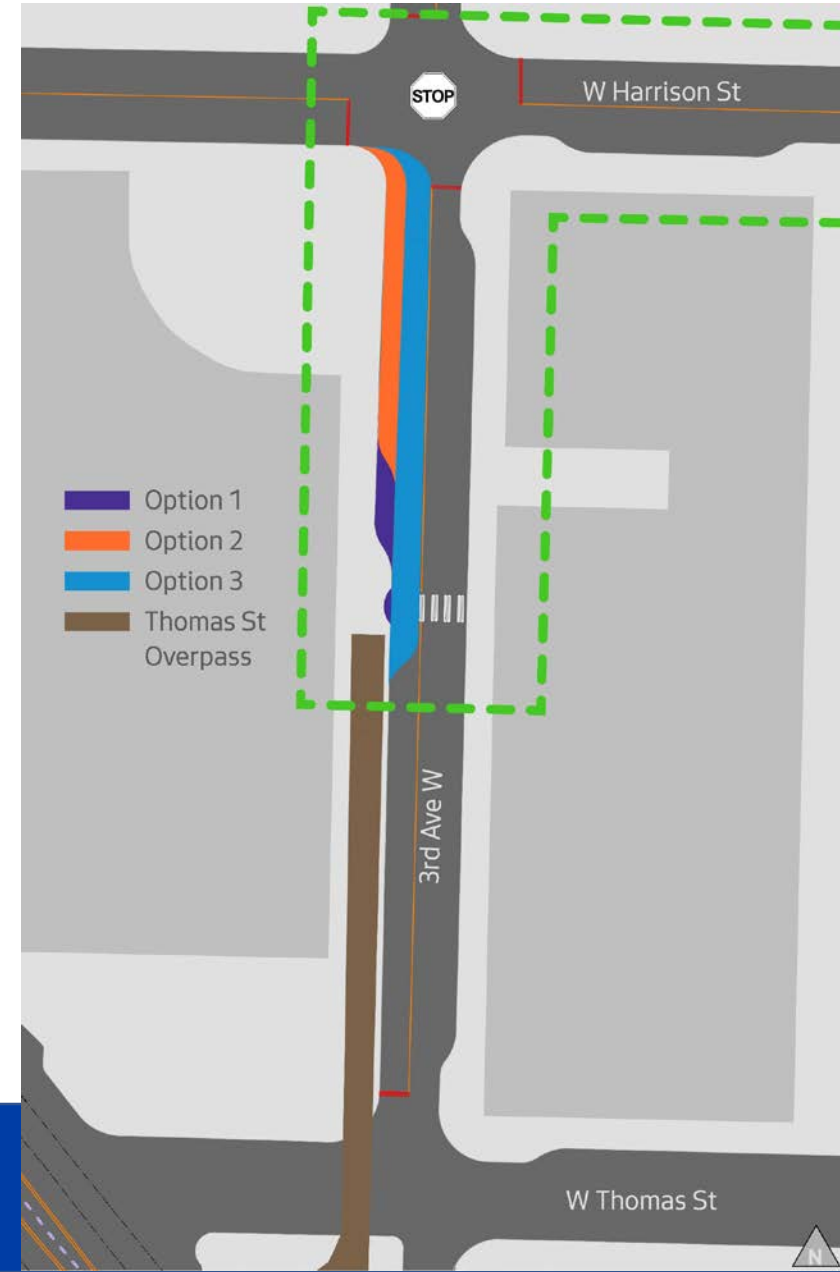

# Websites

- **NODO MAP**

- *<https://www.seattle.gov/transportation/NODOMAP>*

- **Seattle Center to Waterfront NGW**

- *<https://www.seattle.gov/transportation/projects-and-programs/programs/greenways-program/seattle-center-to-waterfront-greenway>*





**Comments/Questions?**